



Yamaha T700 Aurora

Disclaimer: We assume you possess the expertise and relevant tools to work on your machine. We also assume you have the OEM/Stock owner's manual or technical service manual for your machine. If you do not possess the skills, knowledge, or tools necessary to perform the installation of electrical and/or aftermarket parts, please see a qualified service provider.



- Start by removing both side panels.
 - 3 screws on the outside
 - 3 quick fasteners near the radiator
 - Unplug turn signals and set aside
- Under the lower fork clamp remove the 2 bolts that secure the brake line mount and the rubber plug that is inserted into the lower steering stem.
 - Skip this step for high fender mount.
- Install Aurora lights onto the mounting bracket. The cradle will be in line with the light. The curved portion of the light bracket facing upwards. Tighten the light mounting bolt snug now, it is ok for the wires to have a tight bend in them.
- Mount the bracket to the underside of the lower fork mount, **using blue liquid thread locker**, attach the (4) M6x16mm bolts and washers provided.
 - The bend in the bracket faces upward.
 - Replace the factory brake line mount in the rear holes as pictured.

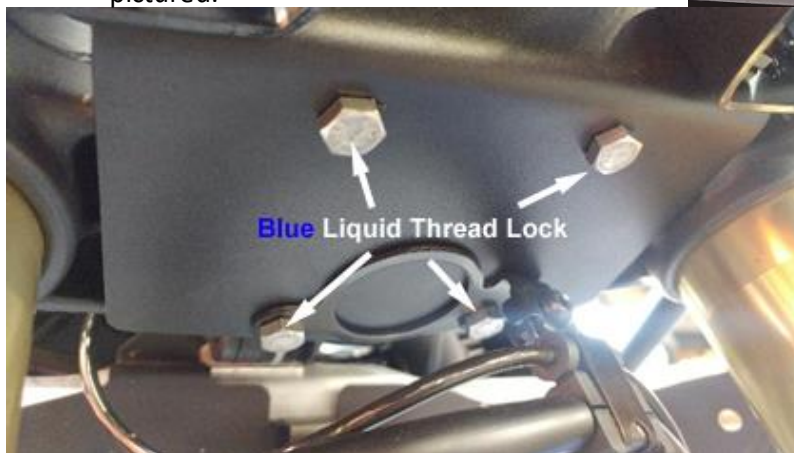
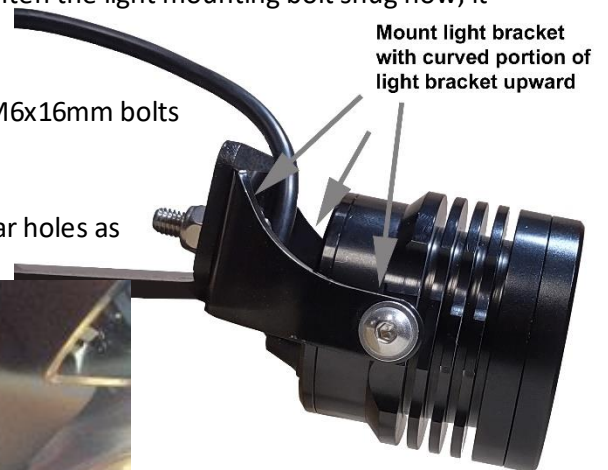

- For the high fender bracket, follow the steps above and secure bracket, **using blue liquid thread locker**, attach (2) M8X20mm bolts.

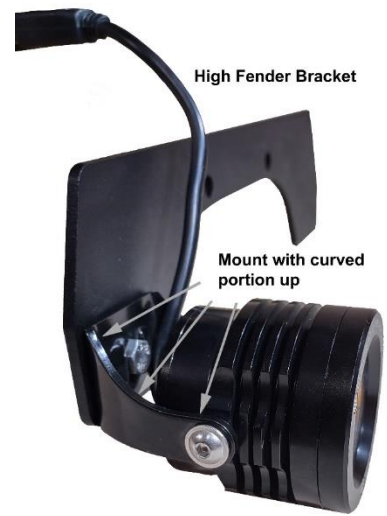

- Mount the dimmer OR relay behind right side panel on brake side of bike.
- Route power wires for dimmer/relay and power for DRL's to the white accessory plug under the fuel tank and on the rearward side of the radiator.

- Mount switch at this time if ordered. Switch will be prewired.
- Insert the wire terminals into the factory connector in the appropriate locations. You will hear or feel a "click" when inserted all the way. Push the silicone gromets into place with a small flat tip screwdriver till they are flat with the back of the connector.
- Route the driving light wires up through the headlight mount bracket (in front of steering head) along with the DRL's power wire.
 - Connect driving lights and DRL's if equipped

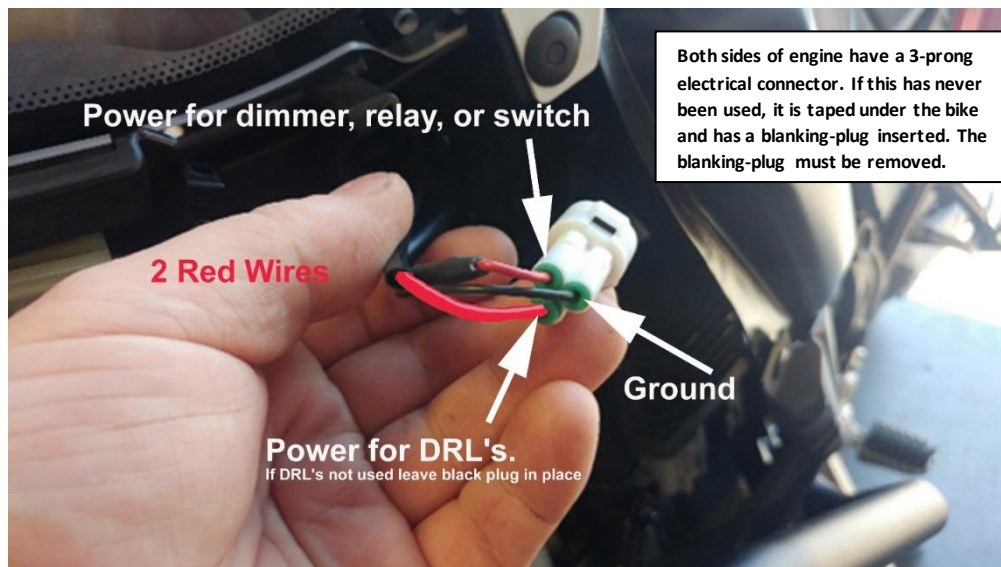
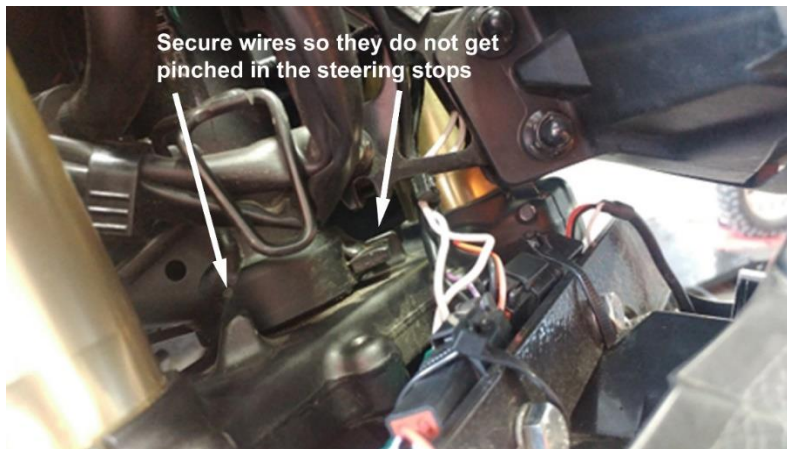

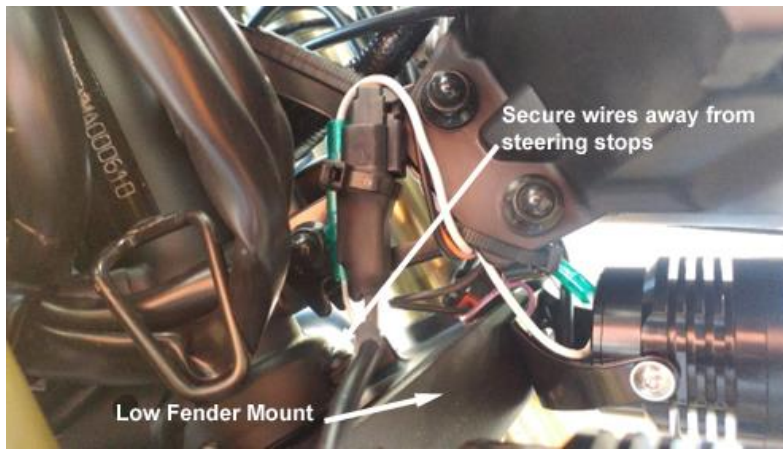

- Locate the headlight plug (black 6 position) and identify the solid yellow wire. Route the trigger wire for the dimmer/relay up to the solid yellow wire on the headlight plug.
- Connect the trigger wire to the high beam wire (solid yellow) using the provided Posi-Tap.
- The trigger wire is single wire on the harness with a Posi-Tap connector on it
- Test the lights to make sure they operate. You will need to start the bike to check all functions.
- If all is working to satisfaction secure all wires with wire ties. Make sure nothing pinches or gets in the way of proper bike functions.

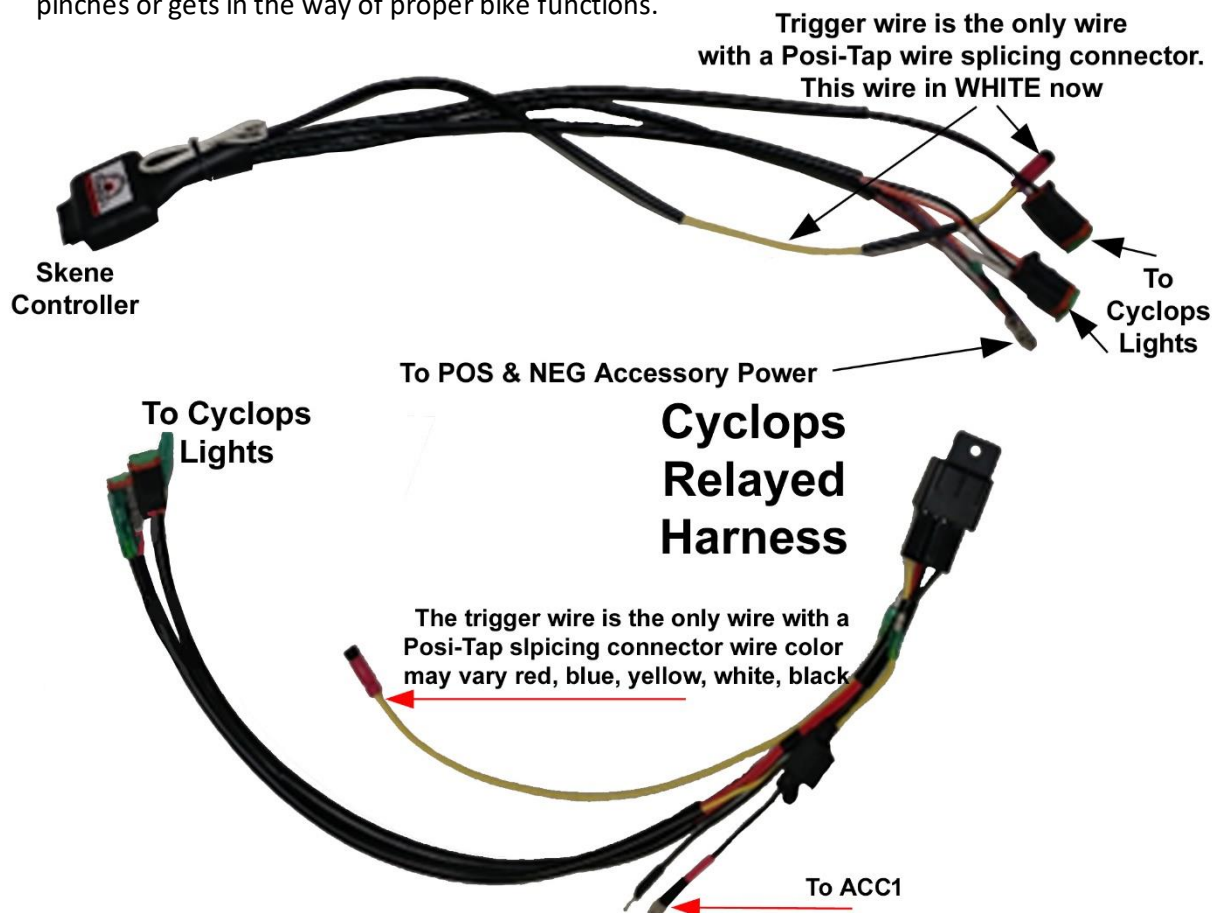

Kit contents depending on order preference

	Item Name	QTY		Item Name	QTY
a	Low fender bracket and bolts	1	e	Relayed harness	1
b	High fender bracket and bolts	1	f	Auroras	2
c	Dimmer harness	1	g	Auroras with DRL	2
d	Switch	1			

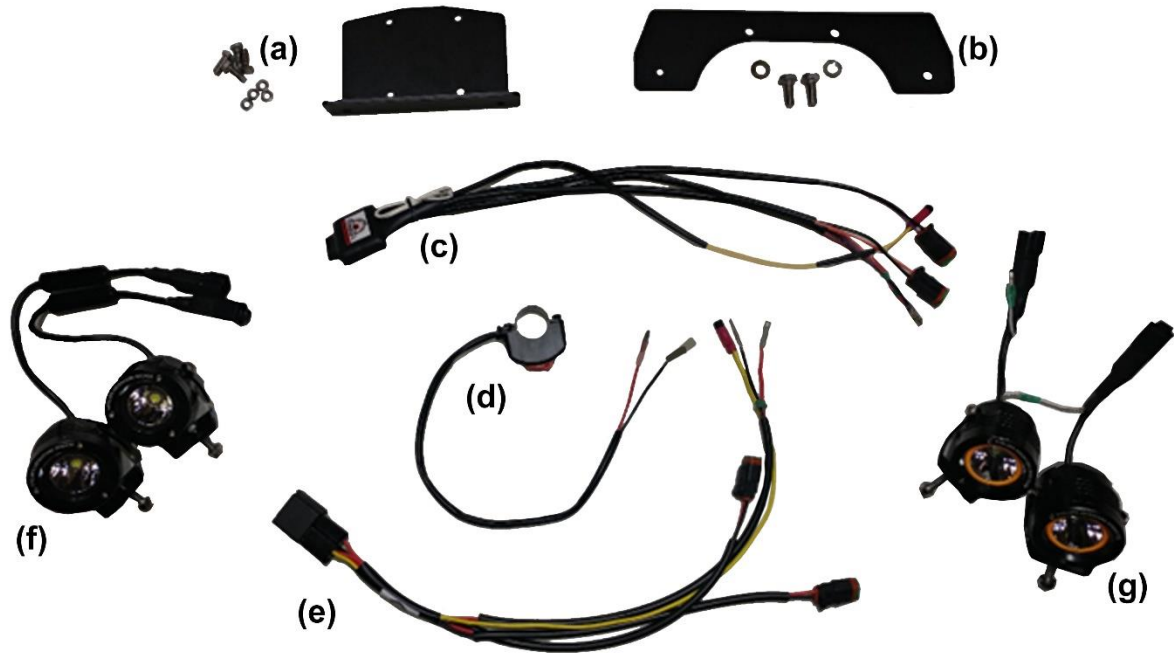

Posi-tap Instructions: black end = remove black cap and place over wire you wish to tap. Insert black cap back into red Posi-tap body and tighten snugly. No wire stripping is needed

Posi-Tap™
TAP CONNECTOR

- TAPS WIRES WITHOUT CUTTING
- TOTAL WIRE INTEGRITY IS MAINTAINED
- INSTALLS IN SECONDS BY HAND
- NO CRIMPING OR TOOLS REQUIRED
- REUSABLE OR PERMANENT
- LESS RESISTANCE
- VIBRATION PROOF
- FULLY INSULATED

QUICK & EASY

- 1 Insert Hot Wire
- 2 Tighten
- 3 Strip Leads
- 4 Insert & Tighten

POWERS UP TO (4) LEADS AT ONCE!

NO CRIMPING

NO TOOLS NEEDED

