

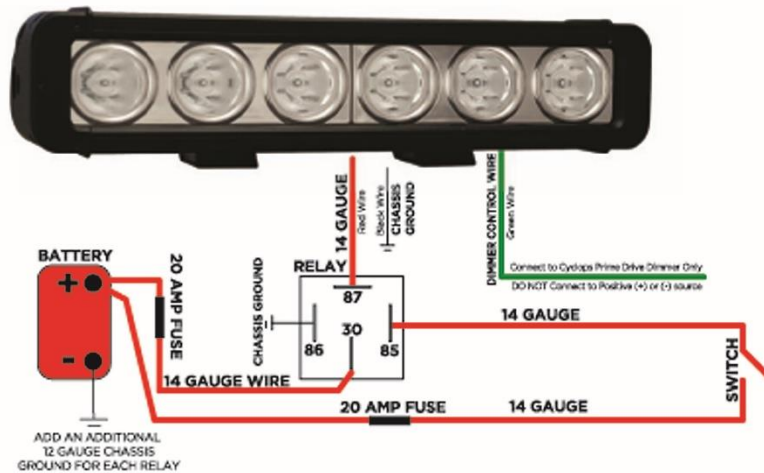

Prime Drive LED Lights (OPR Long Range and Penetrator Light bar)



Disclaimer: Read instructions completely before installation for use of the product. We assume you possess the expertise and relevant tools to work on your machine. We also assume you have the OEM/Stock owner's manual or technical service manual for your machine. If you do not possess the skills, knowledge, or tools necessary to perform the installation of electrical and/or aftermarket parts, please see a qualified service provider.

Mounting

Mount light bar in desired location, keep bottom base nuts snug but don't tighten. Adjust bar so it is centered on the off-road machine. Tight bolt on the bottom of the bracket to 20 ft/lb.

Wiring using included harness

While your light is multi-volt capable, the included relay harness has a 12V only relay. Mount switch provided in harness or if you have your own, its OK to use, connect the fused red wire to positive power source (battery terminal is OK), now carefully route the harness from the mounted switch to the battery and then to the LED light. Connect the 2 black ground wires with ring terminals to chassis ground or negative (-) battery terminal. Connect the fused red wire off relay to positive (+) battery terminal. With all connections made, connect the weatherproof connector on the harness to the light. Test the light now.

Adjust Light

Adjust the light to the desired horizontal height, then use the supplied Allen wrench to tighten both side Allen bolts on each end. A good reference point is to 20ft. the top of the beam should be 3" down from center of light (with the light bar at dead center). Tighten light and enjoy

Custom Wiring (Optional)

All electronics are internal so there is no need to mount external electronics. Each light has a simple two-wire hook up. Red being +12v and black being -12v. Green wire is for Prime Drive

Thank you for your business and please contact us at 1-800-624-0278 with questions

Cyclops Adventure Sports





dimmer Only, DO NOT connect to any other source or ground. Lights should be wired to a switch through a relay with a maximum of 2 lights per relay, up to 12" bars and 1 light per relay for larger, for optimum durability and performance. Each relay should be wired as follows:

- 86- chassis ground
- 85- 12v+ Trigger from switch
- 30- 14, gauge 12v+ from battery (minimum gauge is 14 for 2 lights)

Duplicate relay packs can be wired for additional lights. Switch trigger can be jumped from relay to relay.

Remaining black wire on light should be chassis grounded or grounded to the negative terminal of the battery; making sure ground surface is cleaned down to metal using a stainless-steel bot to secure the grounding ring.

Warning

- Make sure all wiring is away from hot surfaces and moving parts
- After installing lights, be sure to position lamps so they do not blind other drivers. Position your vehicle approximately 20 feet from a wall. The top of the beam projected on the wall should be 3 inches lower than the lights center.
- Do not place lights near anything flammable after being used
- Some vehicles create high voltage upon starting or shut down, do not have lights on when starting or turning off the vehicle.
- Lighting laws and regulations vary by state. Check your local laws before using.
- Let lights cool down before handling after use.
- Do not look directly into lights, doing so may cause damage to the eye.

Posi-Tap & Posi-Lock Connector Instructions: Remove the end cap and place over wire you wish to tap. With wire threaded into cap, tighten cap into the Posi-Tap body.

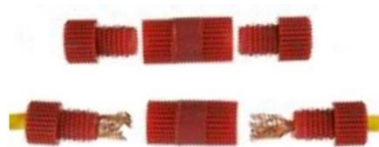

End-Cap type
Connector

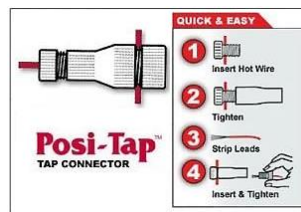
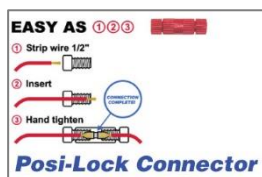

Wire-Splice type
Connector

Thank you for your business and please contact us at 1-800-624-0278 with questions

Cyclops Adventure Sports

