

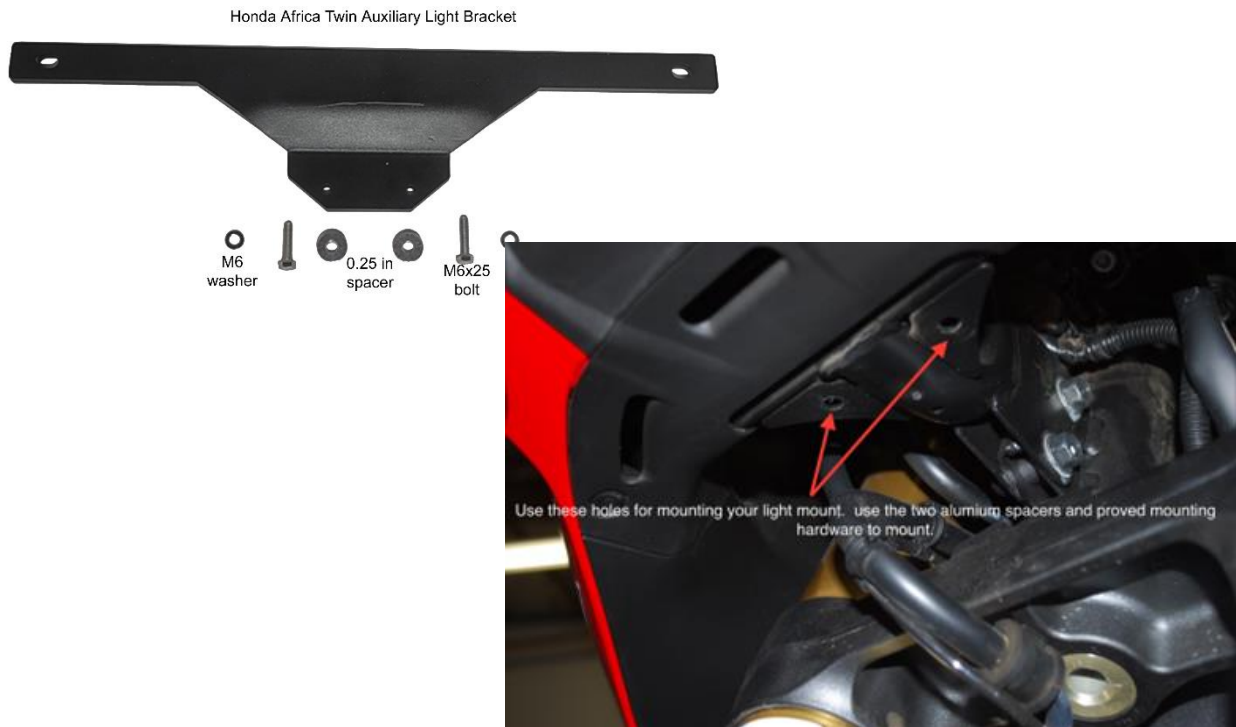

Honda Africa Twin Auxiliary Light Installation Instruction

Disclaimer: We assume you possess the expertise and relevant tools to work on your machine. We also assume you have the OEM/Stock owner's manual or technical service manual for your machine. If you do not possess the skills, knowledge, or tools necessary to perform the installation of electrical and/or aftermarket parts, please see a qualified service provider.

- Start your installation by removing the outer fairing assembly on your motorcycle.
 - This is the hardest part of the installation so take your time keep parts organized and this will help when it is time to reassembly your motorcycle. Reference your owner's manual or other source for specific instructions.
- Remove the inner fairing covering the headlight and dash to access the main headlight plug and the high beam plug.
- Remove the left side turn signal to simplify access to the required plugs.
- You do not have to remove the fuel tank; the main battery wire is the only wire that needs to run back to the battery. This can be routed to the battery box along the frame and at various locations and secure with zip ties.
- Attach the auxiliary light bracket to the bike using the two (2) M6x25 bolts supplied with the mount.
 - Use the provided 0.25-inch aluminum spacers between the light mount location on the motorcycle and the light auxiliary mount for proper clearance.



Cyclops Aux light harness with Skene IQ dimmer
Your harness will come preassembled

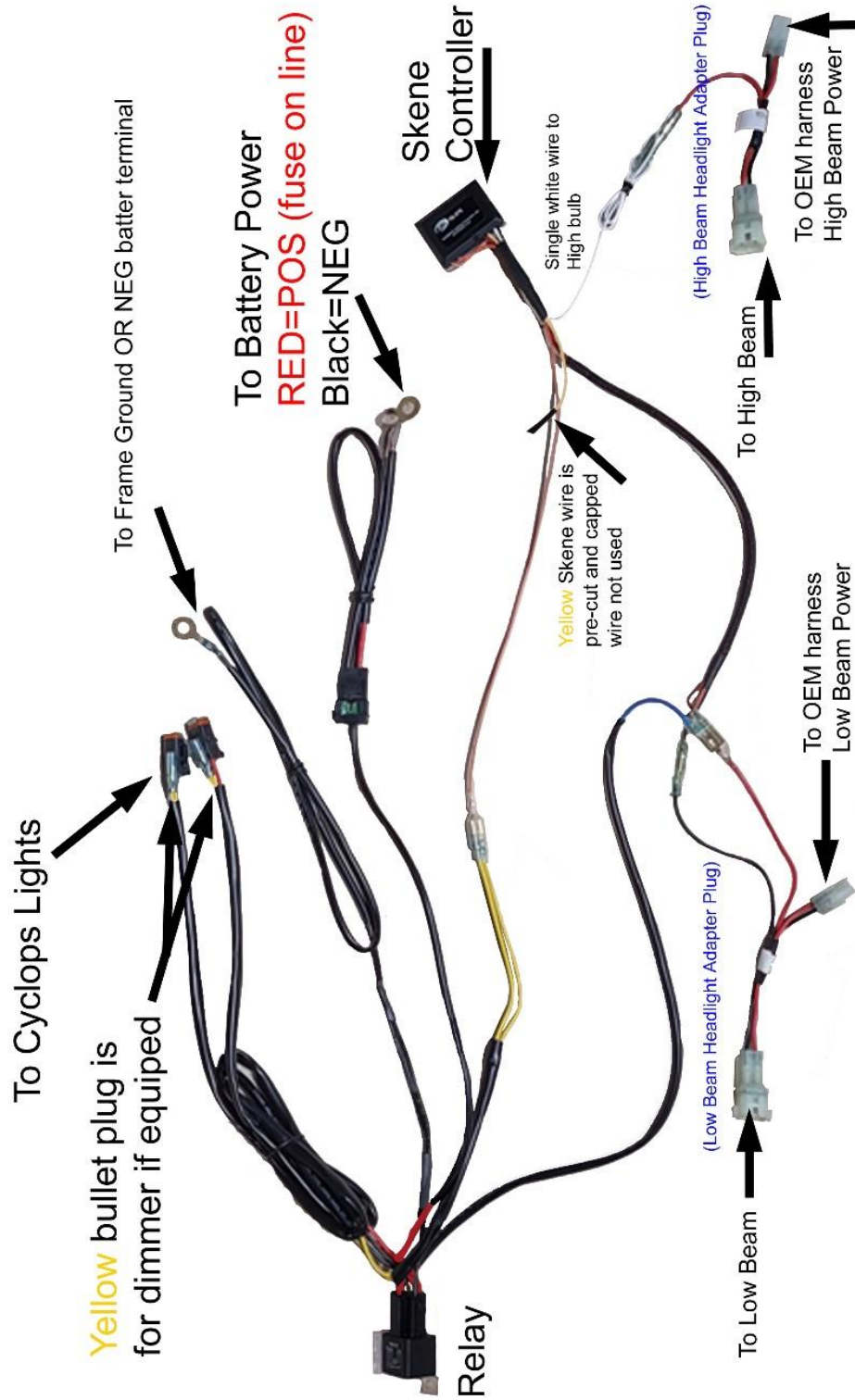

- The Cyclops harness is preassembled based on how it was ordered.
 - If you do not purchase the Skene dimmer, the standard Cyclops Relayed harness will come assembled for plug and play also.
 - Use the same harness diagram to reference each wire attachment if using the standard relayed harness with or without the Skene dimmer controller.

Steps to a successful installation:

1. Route the light wires, ground wire, trigger wire and Skene dimmer wire (if used with Skene dimmer, purchased separately through Cyclops) through the hole on the inside of the left inner fairing to the appropriate locations.



2. Mount relay on the inner left fairing.

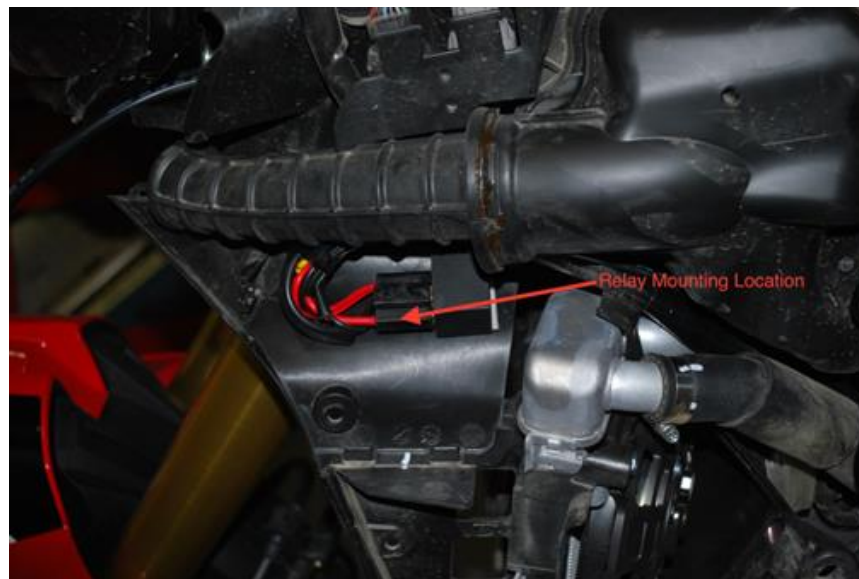

3. Route the battery power cord through the headlight housing and down the frame to the battery box.
4. Install all electrical connections.
 - Install the Headlight Adapter Plugs (low and high beam) from the main Relayed harness into OEM/Stock high and low beam
 - There are only two (2) plugs used in the front of the bike that you must locate to make your lights operational

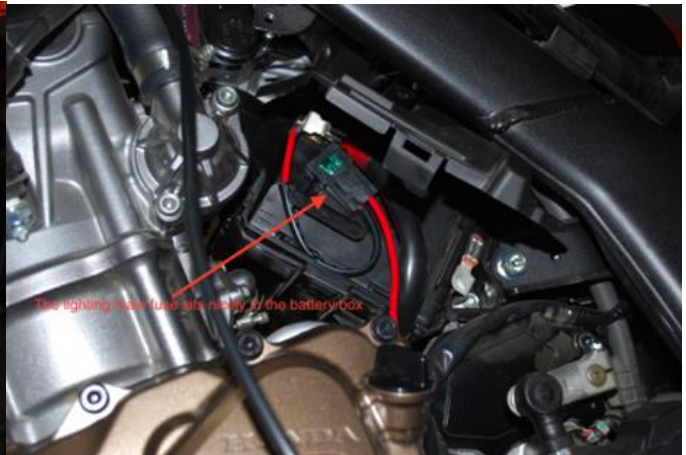
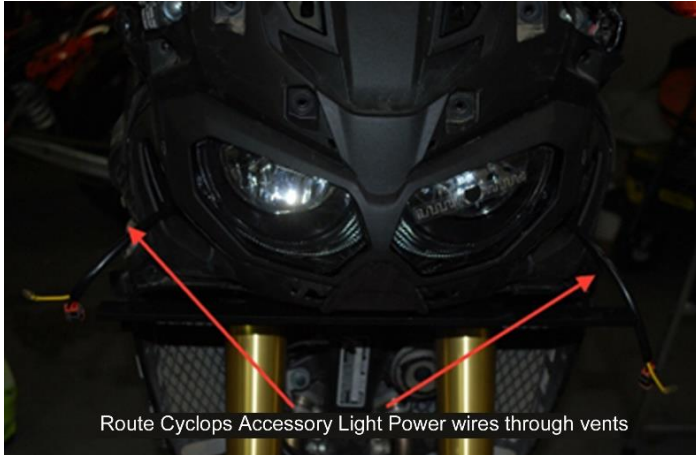

- Black plug is your OEM/Stock low beam connector
- White plug is your OEM/Stock high Beam connector
- Use a small screwdriver to lift the tab that holds the OEM/Stock connectors and separate.
- Insert the Cyclops headlight adapter plug between the OEM/Stock headlight plug and the original OEM/Stock headlight power wire

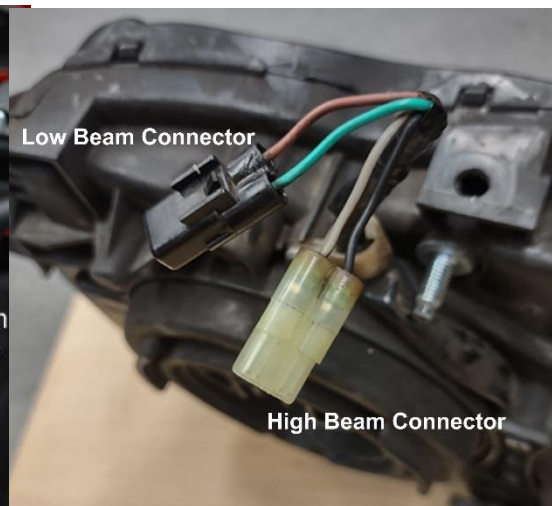
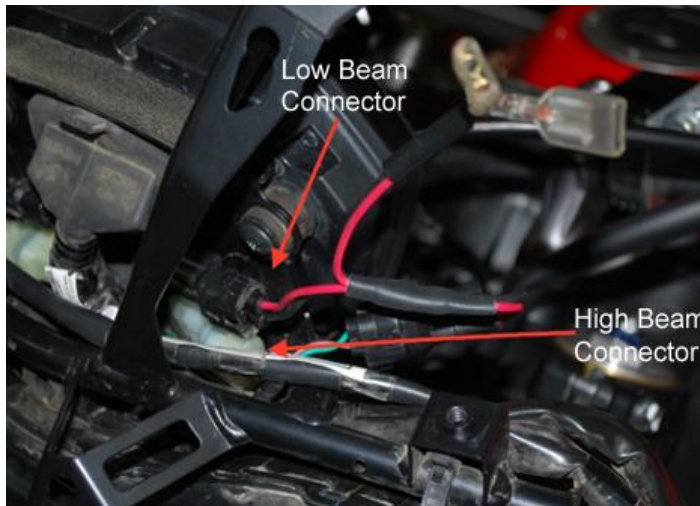

5. Connect frame ground from the main Relayed harness to the frame ground on the bike (OEM/Stock green wires in pictures below) **OR** Negative battery terminal
6. Connect **POS** and **NEG** from main Relayed harness to the battery
7. *Temporarily* Connect Cyclops lights to light harness
8. Test the wire harness installation, carefully attaching the lights to the plugs, connect yellow dimmer wires if your lights are equipped (Optimus LR and



Penetrator light bar)

9. Turn the bike on
10. Confirm proper operation
11. Disconnect the lights accessory lights after testing and reinstall the motorcycles fairing
12. Secure all wires
 - Confirm no pinching or binding of the wires and the steering system operates freely
 - Clean the plastic with rubbing alcohol and use the provided 3M dual lock tape to secure the relay
 - If you are NOT using the Skene Dimmer the yellow wires can be zipped tied and secured out of the way
13. Aim your lights and tighten so the vibration does not upset the positioning

